

Art.-Nr./Item no./N° d'Art. 670755

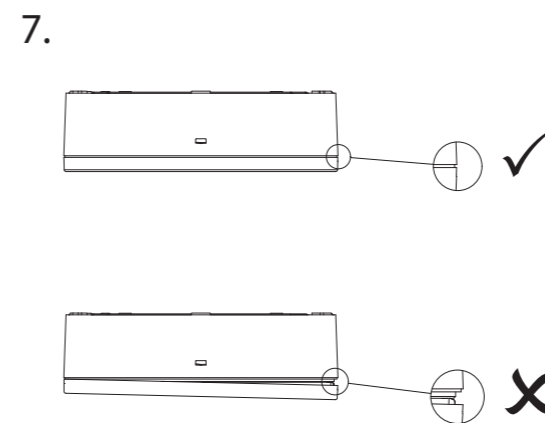

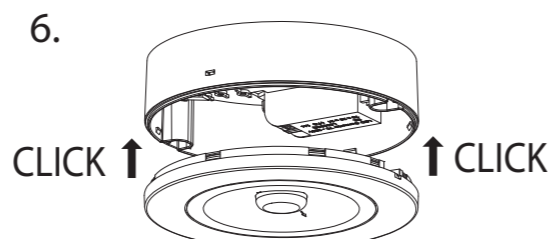

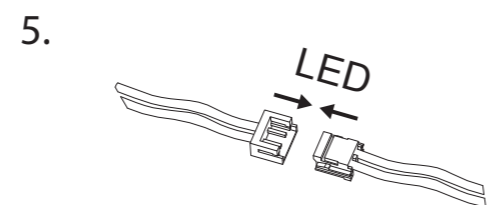

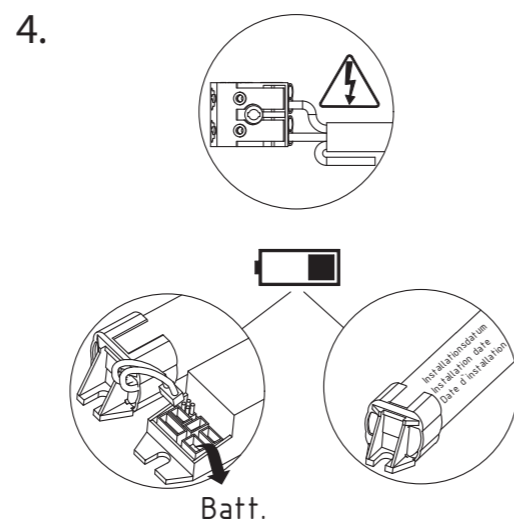
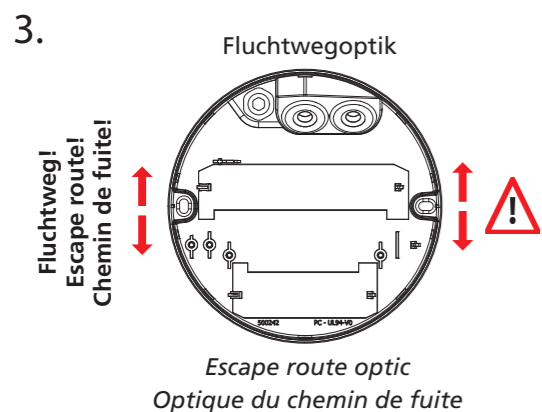
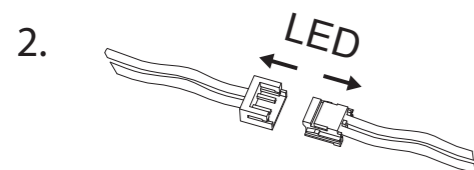
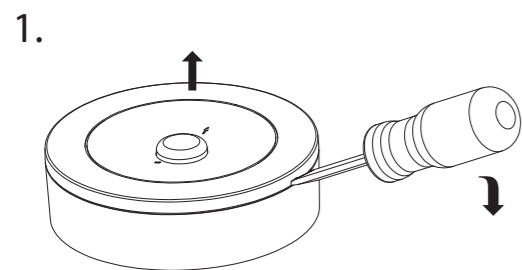
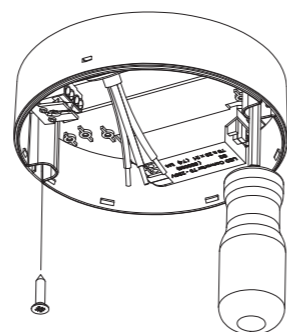
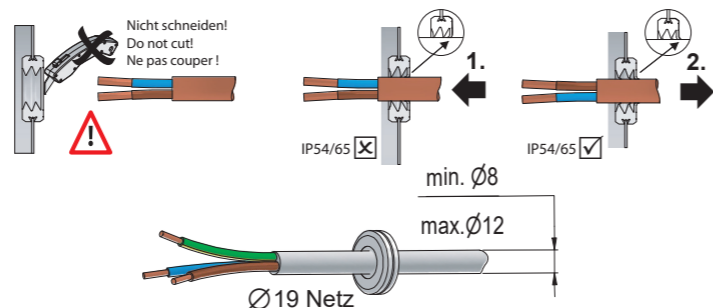
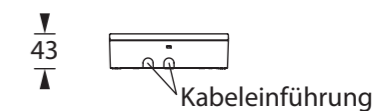
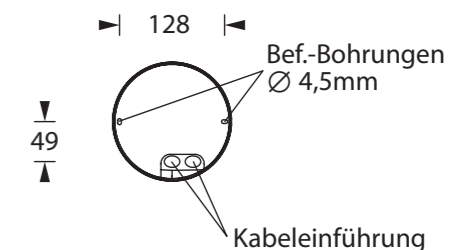
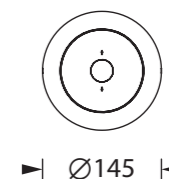
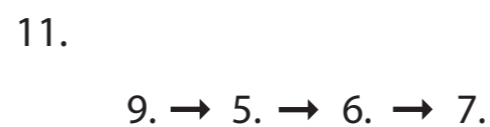
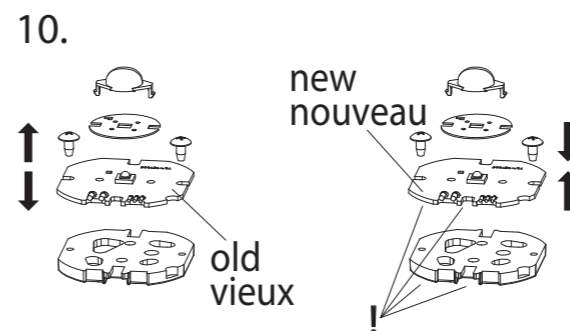
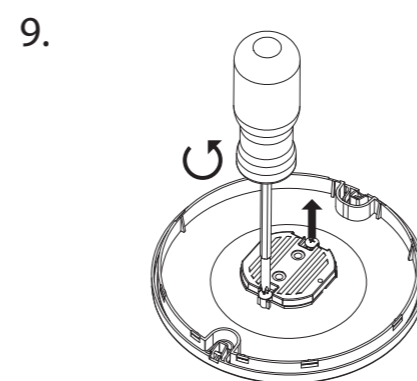
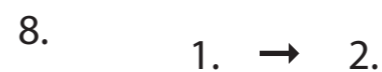

 **Leuchtmittelwechsel**
 **Illuminant change**
 **Agent lumineux variation**



Achtung! Bei Leuchtenausführung mit Rettungsweg-Optik die Lage des Fluchtweges beim Einsetzen der Leuchte beachten! Siehe roten Aufkleber in Leuchte.

Attention! Make sure to observe the correct directionality in regards to the escape route, when mounting lamps with emergency exit optic! See red instruction label inside luminaire.

Attention! Sur les modèles de lampes avec marquage d'issue de secours, respecter la position de l'issue de secours lors de l'installation de la lampe ! Voir l'autocollant rouge dans la lampe.

-  **Kabeleinführung**
-  **Cable entry guide**
-  **Introduction de câble**
-  **Bef. Bohrungen**
-  **existing boreholes**
-  **Perçages existants**

